

**arkitektskol**

**ansvårutställ**

**Ining2015**

**vernissage**  
**28 maj 17.30**

## **Welcome to Lund School of Architecture Spring Exhibition 2015!**

It is with great pleasure we take this opportunity to present selected works of spring 2015. All years, from first to fifth, exhibit their projects in drawings, models and installations. The range of projects is, as usual, wide: from the design of nursery schools in Malmö to projects in Norway's dramatic fjord landscape and the extreme environments of the Philippines.

Lund School of Architecture offers three educational programmes: the five-year programme in Architecture (A), the two-year international Master's programme in Architecture (MARK), given for the first time this year, and the two-year international Master's programme in Sustainable Urban Design (SUDES). Each semester, the school also hosts 35 exchange students participating in advanced level courses.

### **Opening day includes the following:**

- Inauguration by LTH's Dean Viktor Öwall
- Awarding of scholarship in memory of Sara Birnbaum
- Awarding of GHAAS scholarship for the best thesis at the School of Architecture, June 2014 - March 2015
- Awarding of students' teaching prize
- Refreshments and snacks

I would like to express my warm thanks to all students, teachers and other staff who have made this exhibition possible. Special thanks go to our thesis students Alexander Carlén and Kristina Kember, for their great job as exhibition coordinators.

Thank you, all!

### **We wish you all an exciting time at the School of Architecture!**

Christer Malmström  
Head of School, Professor

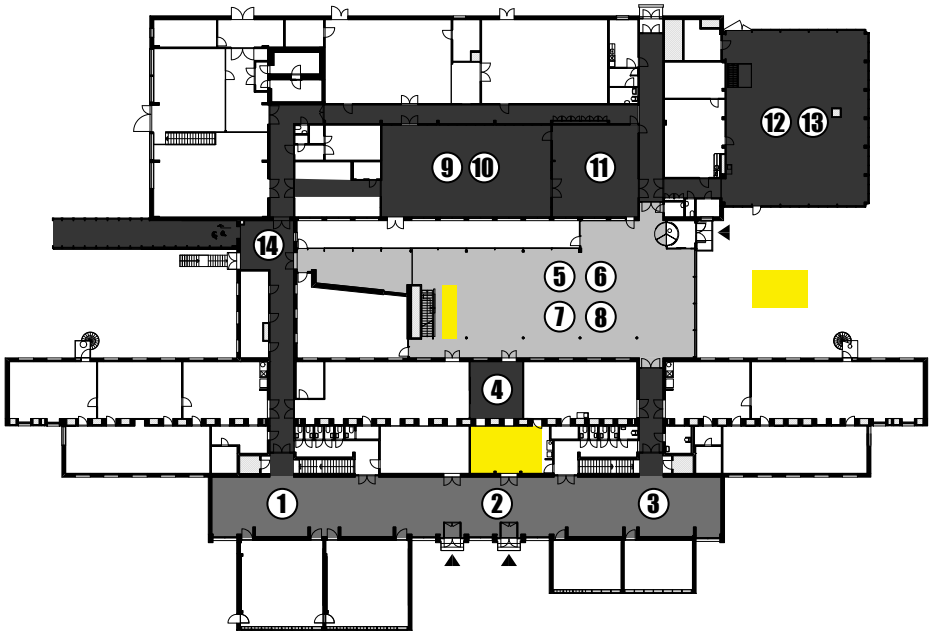

**Basic level**



**Bachelor level**



**Master level**



**Refreshments**

# VARVSTADEN RENEWAL

## COMBINING NEW LAYERS WITH OLD

### Studio director

Göran Hellborg

### Examiner

Christer Malmström

### Course coordinator

Anna Wahlöö

### Assisting teachers

Elin Karlsson, Oskar Tagesson

Architecture and space takes time. The “Varvstaden” project examines changes in space over time. Places, buildings and space are created, used and abandoned. They represent a heritage, an ideal, an era or a lot of different eras. Recycling, changing, transformation for new purposes is important for a society to progress and become more socially, economically and environmentally sustainable. The project raises questions of how to find new approaches, strategies, to combine the new with the old, time with space, sometimes with interaction, sometimes with confrontation. The project investigates spatialities and adds the contemporary - future through architectural generators, springboards, towards an exciting renewal of a central area in Malmö, where labor, culture and dwelling can develop over time.

### Students (bachelor degree projects)

Marie Andersson, Erik Appelgren, Maria Arvidsson, Georg Bothén, Lasse Buhl, Zühranur Celik, Isabelle Easterling, Robin Egnell, Johanna Ericson, Nadja Graham, Christoffer Grimshorn, Sofia Hjelm, Anna Jonsson, Micaela Malmqvist, Malin Markkanen, Synnöve Nyman, Rebecka Peterson, Beatrice Plathner, Johan Strandlund, Elinor Thornblad

# DESIGNING A CREMATORY

## IN THE LIMESTONE QUARRY OF MALMÖ

**Studio director**  
John Ross

**Examiner**  
Christer Malmström

**Assisting teacher**  
Bujar Abazaj

The aim is to, through designing in complex contextual contexts characterized by different time footprints, provide knowledge of architecture spatial characteristics and develop their ability to design architecture in specific physical and socially complex situations. Special focus is devoted to contemporary and future issues that may develop architecture in new directions. This course provides basic information about the contemporary construction and future challenges and how these are discussed and evaluated in practice and theory. Adequate methods are introduced and in an applied design task the students are trained in how buildings/environments can add, update and revise existing built structures both in the short and the longer term.

The design task - the dominant element - is situated in an urban or landscape context. The project work should invite to a critical examination of the architectural foundations and to encourage an experimental approach, where innovative and pioneering solutions are tested.

Students are supervised on a weekly basis and at interim briefings and trained to communicate architecture in a structured and insightful way, in words and pictures. The design task is supported by lectures, workshops, literature and seminars. Final examinations are held at a public briefing where invited external critics are involved.

### **Students (bachelor degree projects)**

August Almkvist Jansson, Raphael Andreolli, Carl Arvidsson, Elisabeth Berg, My Brandt, Vera Ceginskas Lindström, Simon Fast, Cecilia Hansson, Ola Håkansson, Jonna Idsäter, Carl Kvanta, Gerda-Maria Larsson, Emanuel Mettmann, Therese Norgren, Josefin Norrby, Michael Schæfer, Oskar Svahn, Alex Svärd, Zandra Valencia Vargas Skogsfors, Ludvig von Hofsten, Henrik Yang, Rasmus Ylander

# LANDBORGEN

## IN HELSINGBORG

### Studio directors

Maria Rasmussen

### Examiner

Christer Malmström

### Assisting teachers

Bernt Nilsson, Mats White

The steep beach ridge of Helsingborg represents a grand landscape element and extends itself in a north-south direction, around 300 meters from shore.

Architecture in Context examines this great landscape element in the city, and its potential role to be a “city developing” factor. The goal of the course was to, with the help of architectural engagement, strengthen the public space in a situation where the topography serves as both an asset and a challenge. This topography acts as a divider and as unifier, extended and underlining and sometimes totally forgotten.

The project was based upon every-day phenomena and was expected to result in a tangible building project within the range of 500-2000 m<sup>2</sup>. The program was individually formulated by each student with the help of assistant teachers.

The course had, as a point of departure, a growing issue in the field of architecture; how can abandoned/forgotten physical situations be re-introduced into the urban fabric? Examples on this exists throughout the world; the High Line in New York or the shipyard area in Malmö. What unifies these examples with the ridge in Helsingborg is that something, ones considered as a limitation, can be seen as a place of possibilities - and it is in this issue we wish future architects to gain insight.

The course gave insight into a method of working where a great complexity should be handled with an understanding of an underlying history/process; - What has generated “the project” and what is the position towards the “raison d’etre” of the project!?

### Students (bachelor degree projects)

Karl Allemyr, Hugo Barcelona, Eric Bjerkbörn, Elin Delmar, Louise Franzén, Marcus Froste, Julia Gustafsson, Tove Hidemark, Anton Lundblad, Ellen Mendel Hartvig, Oskar Nygren, Tim Näsling, Amanda Paulsson, Christina Sammer, Björn Sjulgård, Maria Sjöström, Nicolas Tennberg, Olivia Ytterström

# BUILDING A PROTOTYPE

## FROM SKETCH TO FINISHED PRODUCT

### Examiner

Lars-Henrik Ståhl

### Course coordinator

Helene Sveningsson

### Assisting teachers

Marcus Andäng, Eeva Ovaska

Architects contribute to the creation of cities, spaces and places. They design buildings, space and objects. Despite this wide range of projects, architects tend to hand over their early drawings to others, and then move on. With this project, which stretches over five weeks, the second year students have the opportunity to develop an idea from the very first sketch to a finished prototype, made by themselves in the school workshop. People of other professions were invited to inspire the students with new approaches towards design, a process the students are not accustomed to, to highlight the creativity of the design process - it can depart from anywhere.

This years point of departure was to create “pop-ups”, inspired by a picture of a historic event, chosen individually by each student together with the artist Andreas Johansson. Ideas arise from the trans boundary, which is one of the qualities of the design process. The purpose is to inspire and drive the project from the first sketch to the final product. Be amazed by the results of the different interpretations of the human history!

# FROM PARASITES TO CITYSCAPES

## A SELECTION OF ATELIER PROJECTS

### Studio director

Andreea Marcu

### Assisting teachers

Ida Lindborg Rasmussen, Liina Pikk

Q is one of the four ateliers at Lund School of Architecture. The 1st and 2nd year students study and work together focusing on the process and methodology as a basis for creative work to achieve both aesthetic and functional architecture. The theme that atelier Q worked with through the year, otherwise general for all the four ateliers, has been - The City. The projects in atelier Q focused on the reading and understanding of transitions from the bigger scale to the smaller, the correlation between different species of spaces and the impact that a small scale structure/insert has on its immediate surroundings, neighborhood and the city. In its explorations Q has used different work methodologies and approached architecture on different levels, such as the mental landscape of meanings, the invisible landscape as geographers Peter Gould and Rodney White refer to (Mental Maps 1974). The invisible landscape, the way we perceive the surrounding environment, the landscapes that shape the interactions and behaviors within the cityscape. As in previous years, the projects were structured in such way that the students got the opportunity to experience and experiment with the combination of theory and practice, collaborating with professionals and individuals outside the school environment.

### Students, 1<sup>st</sup> year

Drenusha Blakcori, Viktor Borg, Pontus Dahlgren, Catrin Frid, Frans Herklint, Hampus Jonason Bjärnestam, Tilda Karlsson, Astri Konradsson, Daniel Nolkranz, Linnea Pettersson, Vera Swahn, Elin Westin

### Students, 2<sup>nd</sup> year

Jeanna Berger, Maria Border, Simon Bring, Elias Brulin, Karl Båth, Christina Gherman, Sara Gråhed, Kajsa Henriksson, Emelie Landström, Malka Logo, Jenny Lähdet, Julia Persson, Theodor Runerheim, Clara Sandell, Erik Stigland, Axel Svenstam, Emil Söderlund, Jakob Vermelin, Thomas Åström



# SOUNDSCAPE

## BUILDINGS TO DO WITH MUSIC IN LUND & MALMÖ

### Studio director

Nina Falk Aronsen

### Assisting teachers

Elin Karlsson, Akane Moryiama, Daniel Persson, Disa Reutersvärd

Flow, beat, pulse and rhythm are words associated with music, but they can also be used as

description of urban phenomena and experiences.

Different locations have their own sounds, which give a certain mood and timbre. These sounds are important as layers of information in the reading of cities. They create certain conditions for use and appropriation. The character of sound(s) is one path of understanding site and city identity.

In the city there are spaces and buildings with music as main focus: Clubs, concert halls, rehearsal rooms ...

The students in Studio X have worked with two sites in Lund and Malmö. Based on the reading and analysis of the site with audio as a focus and take-off, each of them has created a program that in some way relate to music. On the basis of this, they have designed a building.

The exhibition features films that interpret the sites. The films are made as groupwork and as part of the analysis of site. Each student shows a selected part of his or her own project as well.

### Students, 1<sup>st</sup> year

Hanna Bramsford, Clara Emilsson, Eva Eriksson, Elias Grip, Alexia Han, Anna-Maria Hilmersson, Anton Johansson, Astrid Keding, Jesper Lundberg, Ellen Lycke, Mikael Radhe, Daniel Rosengren, Nellie Salgård, Hugo Tersman, Johan Torarp, Hanna Unell

### Students, 2<sup>nd</sup> year

Maria Bjur, Oskar Dagerskog, Jakåp Elg, Philip Lindh, Martin Lorenz, My Lundström, Elias Nyström, Anna Olofsson, Felix Ruder, Julia Sandgren, Sara Sundestrand, Simon Sundin, Sophia Sunsqvist, Kristoffer Benne

# THE MINIMAL LIBRARY

## IN MALMÖ WESTERN HARBOUR

### Studio directors

Jesús Mateo

### Assisting teachers

Isabell Lilja, Niels Pettersson, Malin Svensson, Tomas Tägil

Based on a design method called "the kit of the parts" developed in the 1950s by John Hejduk at the University of Texas, our students are asked to design a very small library in the residential area of the western harbour in Malmö. On a first stage the main focus is placed in composition following a very strict set of rules. By reducing the problem to an assemblage of architectonic elements the students explore different ideas of space relating to an abstract environment. This pre-architecture becomes specific in a second step where rules are discharged and program and context are added.

### Students, 1<sup>st</sup> year

Caroline Alm, Mats Andersson, Linn Boekhout, Gabriel Cankalp, Adam Denguir, Emilia Fehniger, Alice Franzon, Ellen Fällström, Erik Hildorsson, Johannes Håkansson, Maria Kempe, Amanda Möller, Rickard Ramberg, Adam Richter

### Students, 2<sup>nd</sup> year

Linnea Algotsson, Hanna Andersson, Hung Bui, Sanna Carlsson, Christina Eneroth, Elias Friberg, Malin Heikenberg, Jonathan Kerpner, Tor Krag, Sofie Odby, Axel Stolt, Moa Svensson, Viktor Tamm, Josefina Vega Ezpeleta, Daniel Zahedpour Anaraky

# URBAN SPACE 5: PLAYING HUMANS

## DESIGNING A NURSERY SCHOOL IN MALMÖ

**Studio director**  
Monika Jonson

**Assisting teachers**  
Per Hallström, Elin Karlsson

After one year of intense studies of the urban space, including Paris - the town of flaneurs, the Atelier Z-students are now developing their visions in their final project Urban Space 5 – Playing humans. The point of departure is "Arkitekturstaden Malmö" (Malmö, Town of Architecture) – a brand new tool for dialogue that with 9 theses aims to use architectural knowledge as a fundament now that Malmö strives to reach even further as a model in the field of urban design. Here the students interpret the theses visually.

The principal design task has been to design a nursery school in which architecture plays the key role in creating the best conditions for playing humans at all ages. Crossing boundaries – physical as well as social – has been one of the key objectives. The sites are centrally located in Malmö: one is between the Catholic church and Borgarskolan, the other in a challenging urban context at Södervärn.

Combining the nursery with another public activity, of their choice, is yet another objective. This will not only give the students a good opportunity to shape the urban space explicitly, but also create chance encounters and new conditions for urban life!

The Atelier Z-students interpretations will be part of Malmö stad's ongoing work with Arkitekturstaden Malmö.

### Students, 1<sup>st</sup> year

Susanne Bengtsson, Julia Eliasson, Amanda Forser, Linus Hedrén, Moa Holmgren, Andrea-Louise Jörgensen, Hampus Larsson, Tom Lundin, Fabian Martinsson, August Nordqvist, Rasmus Rosenblad, Sigrid Thunberg, Edouard Tressol

### Students, 2<sup>nd</sup> year

Matilda Ahlbäck, Simon Andén, Axel Bahri, Johanna Bengtsson Salomonsson, Clara Blasius, Ängelkott Bosczo, Otto Carstens Exne, Kristina Ehrling, My Helger, Judith Kollberg, Tomas Lazar, Josefine Nilsson, Felicia Olofsson, Johan Stertman, Karl Warrol

# JUXTAPOSITION OF SPACE

## BY THE USE OF COMPUTATIONAL TOOLS

**Studio director**  
David Andréén

**Examiner**  
Lars-Henrik Ståhl

The studio is focused on the juxtaposition of space, and the mediation of spatial identity and function across architecturally created boundaries. Starting in workshops exploring morphogenetic processes in nature and textile craft, we have explored how parametric design tools and processes can help architects and designers to reinvent the function and identity of the urban space. We strive to create new adjacencies, redefine what is possible, and weave a new pattern rejecting binary simplicities.

We make extensive use of computational tools, but reject the stylistic hegemony of the spline, or “parametricism”. Instead, we seek to extend the reach and capability of the designer, using computational tools to investigate new processes, integrated function, and an aesthetic of discontinuity and multiple identities.

### **Students**

Wiktör Bergh, Jon Bossuyt, Markus Hanning, Tobias Henriks, Eva-Maria Lisa Körber, Henry Lanhamn, Javier Muel Campo, Alexander Måsan

# URBAN ROOFS

## INTRODUCING A NEW ARCHITECTURAL TYPOLOGY

### Studio director

Christer Malmström

### Assisting teachers

Andreea Marcu, Bernt Nilsson, Jesús Mateo

The Master studio of Advanced Architectural Design is focusing the understanding of how the architectural design mixture potential can contribute to the development of society and how different architectural typologies can enrich and activate the urban space. The theme tackled by the students through the spring semester was - The Urban Roof. A notion both familiar and yet unknown, the urban roof and its potential were investigated and then introduced in an urban setting as a new architectural typology. The students' efforts were channeled around researching, understanding and challenging of the notion, then applying and exploring the architectural possibilities for designing an urban roof in a contextual framework tied to both the site and community. The two Sweden based sites used for this projects are situated in Lund and) Malmö.

### Students

Jurate Cirtautaitė, Olaf Dunski, Kristina Finné, Jon Fjellstad, Sara Gustafsson Håmark, Robert Janson, Fanny Jiseborn, Xiangyi Li, Ting Liang, Karin Lindström, Olof Marnung, Margaret Metchev, Kajsa Nilsson, Jenny Nygren, Malin Nylander, David Nyman, Selime Osman, David Ottosson, Jose Antonio Paredes Estrada, Moa Paulin Hansson, Sylwia Pilacik, Disa Reuterswärd, Hanna Sahlström Negash, Behrooz Taleb, Matias Sander Thomsen, Viggo Thormark Fröst, Emilia Thurin Melin, Kristina Ullberg, Tin Pui Wong

# REVITALIZING NYHAMNEN

## TRANSFORMATION OF MODERNISTIC ARCHITECTURE IN MALMÖ

### Studio directors

Thomas Hellquist, Ingela Pålsson Skarin

### Course coordinator

Sibylla Wiegert

### Assisting teachers

Frans Liliedahl, Laine Montelin

Modernistic Architecture changed the traditional design process of architecture in the 21<sup>st</sup> century. For the first time ever: role models for style were not to be found in the architectural history, but in the growing industry and mass production.

In the spring's studio of Modernistic Architecture we investigated how to revitalize heritage from the recent past in Nyhamnen, in Malmö's harbor. With input from the stakeholders involved, programme- and analyze studies, the studio focused on sketching and discussions in creating design concepts for sustainable transformation projects so as to save the modernistic architecture of Malmö.

The study trip took us to the origin of the modernistic movement in Germany with visits to the Bauhaus school, the Fagus factory, the AEG Werk and the Einstein Turm in Potsdam among others.

The aim with the "ABVN06 Modernistic Architecture – renewal, theory", was to scrutinize means and methods of how to transform and revitalize the modernistic architecture in a sustainable way. With the input from lectures, literature and discussions in theory we analyzed what signifies the architecture of the early 20th century and analyze what it means for us today. We have today's values assessments, the deteriorating existing constructions at risk and the present contexts to consider. What can or shall be saved and why?

### Students

Giovanna Cibim, Jacob Everhed, Kristina Jermer, Agnes Johansson, Emmi Juslin, Zainab Majid, Catrin Malmgren, Saara Mutanen, Stina Olofsson, Antoine Piquemal, Hanna Ranstad, Henrik Rosenqvist, Richard Sjöberg, Tove Sthen, Ingrid Tufvesson

# URBAN SHELTER

## METRO MANILA

### Studio director

Johnny Åstrand

### Assisting teachers

Erik Johansson, Laura Liuke, Maria Rasmussen

Urban shelter development in an international perspective focusing on the conditions of the urban poor is a challenge for many. How should architects work with urban shelter design now and in the future? The task of the students in this course is to design a high density resilient housing area in Metro Manila, the Philippines, after having studied the local context for three weeks.

Important issues include population density, urban segregation, affordability, resilience, public space, safety and security, gender and physical planning, climate smart design, slum-upgrading, finance for low-income housing, organized self-help housing and the role of the architect.

The course is divided into three phases: 1. Preliminary studies in Lund, 2. Field study, three weeks in Metro Manila, 3. Applications and design in Lund.

Field study was carried out in close cooperation with the University of the Philippines – Faculty of Architecture, the National Housing Authority, DMCI Homes, Quezon City and TAO-Pilipinas

The design exercise includes design of a residential neighborhood as group work on two alternative sites and individual design of a building. Short films have also been made as group work reflecting on environment, culture and architecture.

### Students

Samuel Banyard, Manon Dol, David Falk, Paola Garnousset, Petter Hultqvist, Elin Johansson, Elin Karud, Hanna Larsson, Xi Luo, Louise Mattsson, Ragnvi Melin, Anna Moroni, Hélio Munhoz Buba, Margo Neemela, Amanda Oskarsson, Gaudy Orejuela, David Rojas, Sigurlin Rós Steinbergisdottir, Alexina de Roux, Cristine Sayuri Szemysk, Malin Svensson, Tomas Wahlstedt, Junyi Zuo, Kim Öhrström

# BY THE WATER | WITH THE WATER

## WORKING IN NORWAY'S FJORD LANDSCAPE

### Studio directors

Louise Lövenstjerne, Peter Sjöström

### Assisting teachers

Edda Ivarsdottir, Nevena Krilic, Constantin Milea, Andreas Olsson

One of the globe's most important challenges today is how to develop, transform and refine our existing cities to be more sustainable. How to make them greener, denser and more fair at the same time. As urban designers we have to respond to this and by thinking in a holistic way, put up goals, strategies and create carefully designed, humane and inclusive urban environments in new ways.

The semester in Sustainable Urban Landscape deals with urban design in a wider perspective – the whole urban landscape. The design project starts out from the understanding that cities are not isolated from their surroundings and must be discussed on a regional scale to create specific conditions for bottom up growth.

The course focuses on design with regard to cultural and natural landscapes, within the general aim of balancing the competing relations between natural and human designed systems. The studio takes on the urban-rural fringe as a rich interface aligning community living, infrastructures and landscape and challenges the students to engage in experimental reflection through design to open fresh perspectives for sustainable living situations where the city meets the landscape.

### Students

Richard Almenius, Roan Atkins, Qendresa Avdiu, Natta Borisoot, Ellen Carlquist, Fiona De Heer, Ermias Desyibelegn Abegaz, Jonna Ekholm, Maria Ferrer Morey, Andreas Gårdendal, Anna Cecilia Holand, Lucile Hubert, Mattias Häggblom, Du Jingyuan, Rozalie Kasparova, Emma Larsson, Moa Larsson, Tiffany Liew, Ruth McDonnell, Sofia Melin, Lucas Momponte, Max Märkel, Teres Nilsson, Arnold Nyawanga, Cristina Soler de Lema-Ossorio, Anna Palmiera, Alana Peddie, Katrin Petursdottir, Pascale Sophie Pilcher Roberts, Sylvia Platteeuw, Kim Rosén, David Svensson, Sandra Svensson, Ina Tumpele, Theo James Valentine, Inta Vaska, Netsanet Weldu Teklu, Märta Wictorin, Liam Williamsz, Chloe Yifan Zheng



# DEGREE PROJECTS

## IN ARCHITECTURE AND SUSTAINABLE URBAN DESIGN

### Examiners

Christer Malmström, Emma Nilsson, Gunnar Sandin, Peter Siöström, Catharina Sternudd, Lars-Henrik Ståhl, Tomas Tägil, Johnny Åstrand

### Supervisors/critics

David Andréen, Nina Aronsen, Kerstin Barup, Lina Dahlström, Peter Fröst, Per Gustafsson, Göran Hellborg, Maria Johansson, Sandra Kopljär, Gunilla Kronvall, Mattias Kärrholm, Alexander Lenre Simittchiev, Džiugas Lukoševicius, Louise Lövenstjerne, Christer Malmström, Jesus Mateo, Bernt Nilsson, Emma Nilsson, Maria Rasmussen, John Ross, Gunilla Svensson, Tomas Tägil, Alex van de Belt, Cecilia Wendt, Johanna Wittenmark

### Students, Architecture

Elinor Andersson in team with Anna Postlind, Nils Baltazard, Manuel Cespedes, Rebecka Engvall, Jonathan Gertson, Sanna Haagen, Camilla Henricson in team with Karin Nord, Christoffer Justusson, Mathilda Karlsson, Felicia Klasson, Martin Nilslund, Karolina Nilsson, Jarand Nå, Fredrik Linander, Linus Mannervik, Ajla Mujanovic, Christopher Polteg, Henrik Ålund

### Students, SUDes

Ahmed Alaydi, Cassandra Alves, Raluca Axante, Mustakima Hussain, Alexis Zohlen



THANK YOU FOR VISITING  
OUR SPRING EXHIBITION!



HOPE TO SEE YOU  
AGAIN NEXT YEAR!





